



## Cowper Road, London

Located on the quiet Cowper Road in the heart of Poets Corner, this three-bedroom home offers a rare opportunity to live in one of Acton's most desirable residential areas. Poets Corner is well-regarded for its distinctive character, defined by its avenues named after celebrated literary figures, and a strong sense of local community.

The property itself comprises a spacious front reception room, a secondary dining area, and a separate kitchen/dining space. A ground-floor bathroom adjoins the rear of the house, and upstairs there are three well-proportioned bedrooms. The layout offers potential for reconfiguration and extension, including to the rear and into the loft (subject to the necessary consents).

- Three-bedrooms
- Period terrace home
- Potential to extend (STPP)
- Poets Corner
- Close to Acton Main Line (Elizabeth Line) and Acton Central (Overground)
- Chain-free

£870,000

# Cowper Road

Approximate Gross Internal Area  
1023 sq ft - 95 sq m

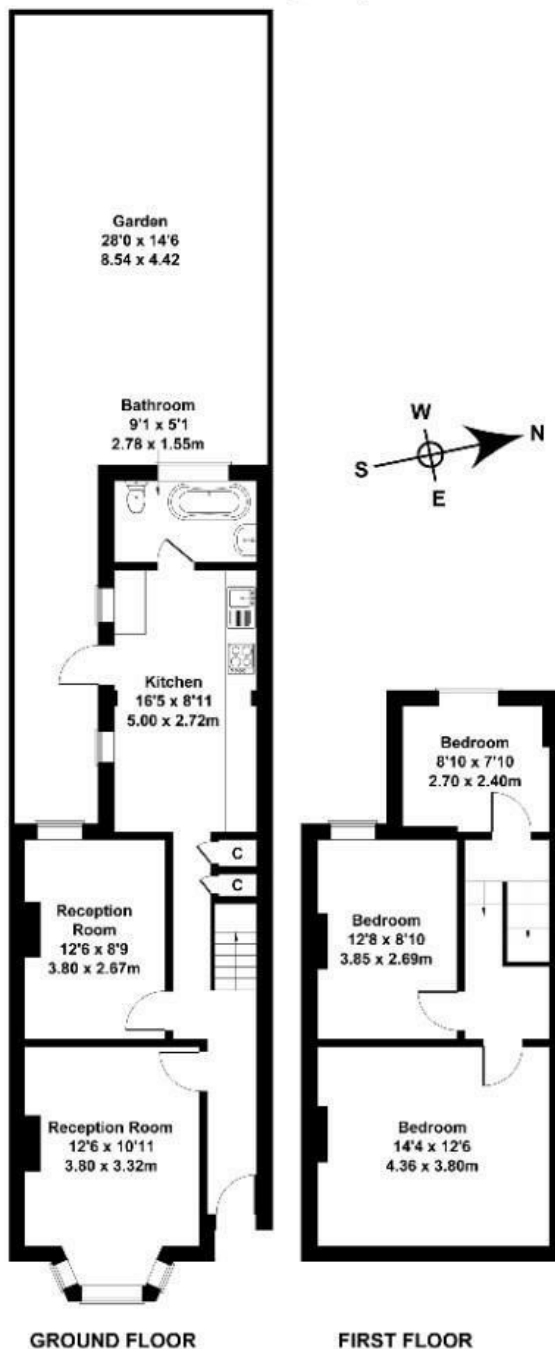

Not to Scale. Produced by The Plan Portal 2025  
For Illustrative Purposes Only.

